



AIRCHARGER®

HIGH-FLOW INTAKE KITS

NOT LEGAL FOR SALE OR USE ON ANY POLLUTION CONTROLLED MOTOR VEHICLE IN CALIFORNIA OR STATES ADOPTING CALIFORNIA EMISSION PROCEDURES.
See knfilters.com for CARB status on each part for a specific vehicle

INSTALLATION INSTRUCTIONS

63-2626
FORD
2024 MUSTANG GT
V8-5.0L

TOOLS NEEDED:

- Ratchet
- Extension
- 7mm Socket
- 8mm Socket
- 10mm Socket
- 10mm Wrench
- T20 Torx
- 2.5mm Allen Key
- 4mm Allen Key
- Pliers
- Small Flathead screwdriver

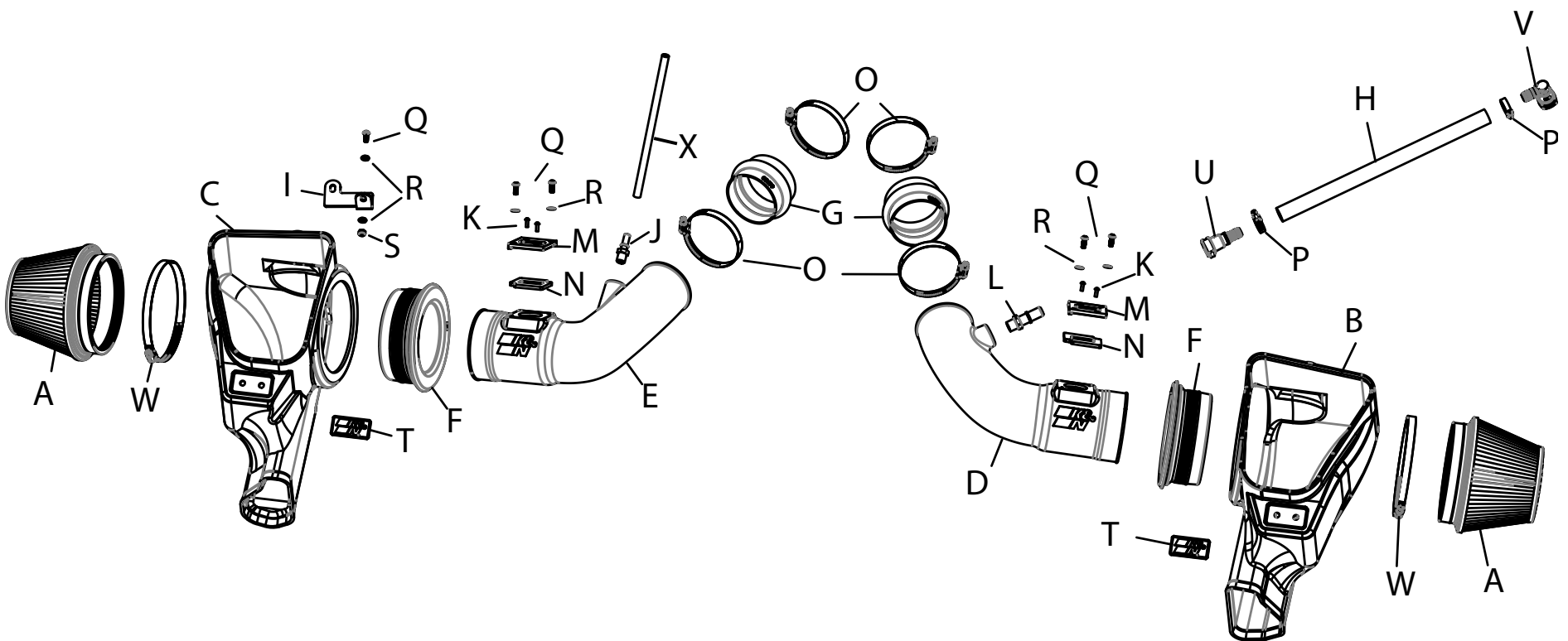

PARTS LIST:

Description	Qty.	Part #	Description	Qty.	Part #	Description	Qty.	Part #
A AIR FILTER	2	RU-2960XD	I BRACKET; "Z", 63-2626	1	064381	Q BOLT; M6 X 1 X 16MM BUTTON	5	07730
B AIRBOX; DRIVER SIDE	1	087586	J VENT; 1/4" QUICK CONNECT	1	82630	R WASHER; 6MM FLAT, SS	6	08269
C AIRBOX; PASS SIDE	1	087587	K SCREW; M4-.7 X 12	4	07726	S NUT; 6MM NYLOCK	1	07512
D TUBE; DRIVER SIDE	1	087588	L FITTING; QUICK CONNECT 3/8"	1	82637-1	T BADGE; PLASTIC, SNAP-IN	2	088096
E TUBE; PASS SIDE	1	087589	M ADAPTOR; MAF SENSOR	2	21515-1	U FITTING; QUICK DISCONNECT	1	08526
F ADAPTOR; RUBBER	2	21572	N GASKET; PORON	2	09069	V FITTING; QUICK DISCONNECT	1	KITFITTING33
G HOSE; HUMP 3.5"ID X 2.5"L	2	08699	O HOSE CLAMP; #56, BLACK	4	08620KA	W HOSE CLAMP; #104, BLACK	2	08697KA
H HOSE; 5/8"ID X 15"L	1	5-7015	P HOSE CLAMP; #10 MINI	2	08411	X HOSE; 3/8"ID X 10"L	1	5-1010

If you need any assistance please call 1-800-858-3333 to speak with a representative in our Customer Service Center before returning the product.

NOTE: FAILURE TO FOLLOW INSTALLATION INSTRUCTIONS AND NOT USING THE PROVIDED HARDWARE MAY DAMAGE THE INTAKE TUBE, THROTTLE BODY AND ENGINE.

TO START:

1. Turn off the ignition and disconnect the negative battery cable.
NOTE: Disconnecting the negative battery cable erases pre-programmed electronic memories. Write down all memory settings before disconnecting the negative battery cable. Some radios will require an anti-theft code to be entered after the battery is reconnected. The anti-theft code is typically supplied with your owner's manual. In the event your vehicles anti-theft code cannot be recovered, contact an authorized dealership to obtain your vehicles anti-theft code.



2. Release the locking tab and then disconnect the CCV hose quick connect fitting from the driver side intake tube. Release the locking clip and then disconnect the driver side MAF electrical connection.



3. Remove the bolt that secures the driver side air filter housing to the inner fender.



4. Loosen the hose clamp that secures the driver side intake tube to the throttle body. Disconnect the intake tube from the throttle body, lift the air filter housing to dislodge it from the mounting grommet and then remove the complete driver side intake system.



5. Release the locking tab and then disconnect the EVAP hose quick connect fitting from the passenger side intake tube. Release the locking clip and then disconnect the passenger side MAF electrical connection.



6. Remove the bolt that secures the passenger side air filter housing to the inner fender.



7. Pull back the relay from the fuse box assembly and set aside to allow clearance for air filter housing removal. Remove the complete passenger side intake system.



8. Remove the EVAP hose from the engine. Remove the quick connect fitting from the factory EVAP hose and install it into the provided longer EVAP hose.



9. Install the longer EVAP hose assembly onto the check valve fitting.



10. Assemble the new Crank case line with provided quick connect fittings and mini clamps. Secure and tighten.



11. Disconnect the OEM plastic crank case hard line and remove from vehicle. Install the new crank case rubber line into the vehicle.



12. Using a smaller flathead screwdriver. Lift the tab from the bottom and remove the metal tab from the fuse box. Set the Relay harness off to the side.

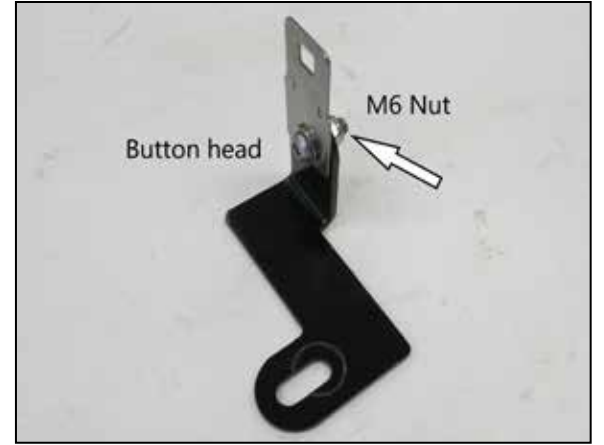

13. Now install the metal tab to the provided bracket. Secure the metal tab using provided hardware. **Make sure the M6 button head is installed like image shown above.**



14. Install the K&N badges to both driver and passenger air boxes.



15. Passenger side tube, install the gasket to the MAF adaptor. Install the MAF adaptor to the intake tube using provided hardware. Install the 1/4" NPT quick connect to the intake tube and tighten. **Note: Make sure the MAF sensor pad is installed in correct position as shown.**



16. Driver side tube, install the gasket to the MAF adaptor. Install the MAF adaptor to the intake tube using provided hardware. Install the 3/8" NPT quick connect to the intake tube and tighten. **Note: Make sure the MAF sensor pad is installed in correct position as shown.**



17. Install the air filters into the air boxes. install the rubber filter adaptor into the air box, push the rubber adaptor into the airbox, and install the air filter onto the adaptor and secure with hose clamp.



18. Install the hump hoses with clamps provided to the throttle body.



19. Install both air boxes into the vehicle and secure the driver side using original bolt.



20. Secure the passenger side air box using original bolt and new relay bracket from step 13. Once tighten, secure the relay to the metal tab.



21. Install the Driver side and passenger side intake tubes into the vehicle. Remove the MAF sensors from the stock air boxes and install into the new K&N tubes and secure using provided hardware. **Note: Arrow on the MAF sensors will go in direction towards throttle body.**



22. Reconnect the MAF sensor harness on passenger side and connect the EVAP line to fitting.



23. Reconnect the MAF sensor on the driver side and connect the crank case line.



24. Secure and tighten the clamps on the throttle body.



25. Reconnect the vehicle's negative battery cable. Double check to make sure everything is tight and properly positioned before starting the vehicle.

26. It will be necessary for all K&N® high flow intake systems to be checked periodically for realignment, clearance and tightening of all connections. Failure to follow the above instructions or proper maintenance may void warranty.

ROAD TESTING:

1. Start the engine with the transmission in neutral or park, and the parking brake engaged. Listen for air leaks or odd noises. For air leaks secure hoses and connections. For odd noises, find cause and repair before proceeding. This kit will function identically to the factory system except for being louder and much more responsive.

2. Test drive the vehicle. Listen for odd noises or rattles and fix as necessary.

3. If road test is fine, you can now enjoy the added power and performance from your kit.

4. K&N Engineering, Inc., requires cleaning the intake system's air filter element every 100,000 miles. When used in dusty or off-road environments, our filters will require cleaning more often. We recommend that you visually inspect your filter once every 25,000 miles to determine if the screen is still visible. When the screen is no longer visible some place on the filter element, it is time to clean it. To clean and re-oil, purchase our filter Recharger® service kit, part number 99-5050 or 99-5000 and follow the easy instructions.

NOT LEGAL FOR SALE OR USE ON ANY POLLUTION CONTROLLED MOTOR VEHICLE IN CALIFORNIA OR STATES ADOPTING CALIFORNIA EMISSION PROCEDURES.

See knfilters.com for CARB status on each part for a specific vehicle